



Assembly instruction for Windyy magnetic blockade - tilted window

Instructional video at
www.windyy.pl
www.medos.pl



1 Open wide the window sash.

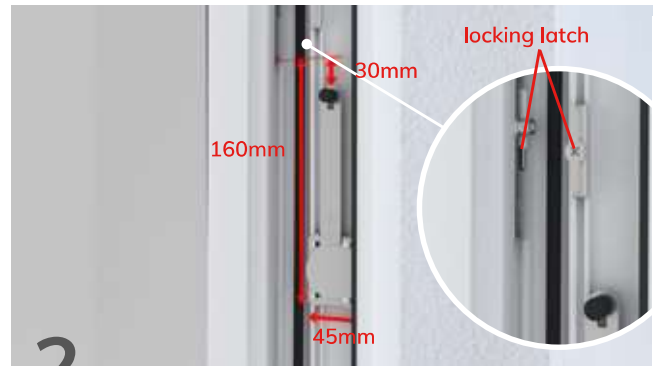

2 Insert the blockade into the window frame at a distance of about 160 mm from the locking latch (it is important that to position the blocking arm to be approx. 30 mm under the locking bolt).



3 Tighten the screws.



4 Set the blockade arm in the groove axis.



5 Close the window



6 Blockade is ready to use



Assembly instruction for Windyy magnetic blockade – window and balcony door sash

Instructional video at
www.windyy.pl
www.medos.pl

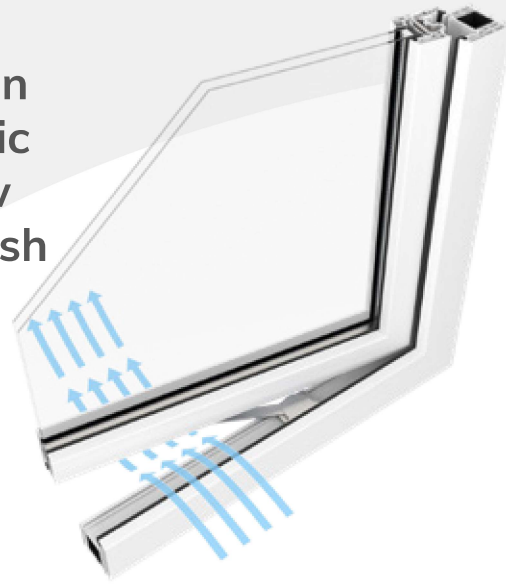

1 Open wide the window sash .



2 Insert the blockade base into the window frame about 60 mm from the inside edge of the window frame.



3 Tighten the screws partially.



4 Insert the Blockade arm into the groove window sash or balcony door groove.



5 Tighten the screws



6 Blockade is ready to use